Strand Woven UniClic® Floating Floor Installation Guidelines

*UniClic® locking system is a revolutionary technology that interlocks your flooring without the need for glue or nails. Please read Bamboo Revolution's warranty, maintenance instructions, and **ALL** of the following guidelines before opening any packaging or beginning your flooring installation. This information is provided as a courtesy to our customers and is to be understood as an installation guideline only.*

Bamboo Revolution recommends using the services of a professional hardwood flooring installer. Failure of floor due to improper installation is not covered by warranty. For more information and guidelines on the installation of hardwood flooring, please contact the National Wood Flooring Association (www.woodfloors.org/consumer).

Because bamboo is a natural fiber, it is not uncommon for natural variations in color to occur within and between individual flooring planks. Bamboo Revolution's warranty does not cover variations in color either in individual planks, between the planks, or the variations in color between our product samples and the installed flooring. An industry standard of 5% material overage should be added to the actual square footage required for cutting and grading allowances.

Recommended Tools

- Rubber mallet
- Miter saw (a.k.a. chop saw)
- Table saw (recommended)
- Underlayment system (Bamboo Revolution 3mm Cork recommended)
- Other helpful supplies: Tape measure, pull bar, spacers, tapping block, chalk line, carpenter square, scribing block, flat bar, ½" wedges, low adhesive painters tape

Pre-Installation Preparation

Allow the floor to acclimate for at least 72 hours in the area where it is to be installed. Leave the flooring in its original packaging and place in the middle of the room. Do not place boxes against the wall or in a corner, and if it must be stacked, do so in a "log-cabin" style to maximize each box's exposure to the room.

Installation should take place at room temperature of at 65°F. A subfloor surface temperature of 59°F must be ensured before, during and for three days after the installation. The relative room humidity should be 50-60%.

Prior to installation, check that doors can still open and close with the addition of the floor and underlayment. We suggest a minimum of 7/8" between the bottom of your door and the top of your base floor. In addition, the door frames may need to be adapted so that the floor can be installed beneath them.

The base floor must be thoroughly clean and flat before the floor is installed. Floors must be level, with no more than 3/16" slope over a 10-foot span. Flatten any unevenness with self-leveling compound and let dry for at least 72 hours.

Bamboo Revolution floating floor can be installed over existing damp-proof flooring (PVC, linoleum, etc.), but cannot be installed over damp-open flooring (carpet, needle felt, etc.). Damp-open flooring must be removed prior to installation.

If installing over concrete, the moisture content must not exceed 2.5% (CM Method). If radiant heat is to be installed, the moisture content may not exceed 1.5% (CM Method). It is also recommended that in addition to an underlayment system, a 15 mil vapor barrier should be laid down over the concrete.

Planning Your Layout

Since bamboo is a natural product, it is subject to expansion and contraction caused by changes in temperature and humidity. Thus, the floor must be allowed to expand in all directions. This expansion can amount to $\frac{3}{32}$ " per yard (the greater the span, the more space it will need for expansion). To facilitate this, allow an expansion gap of $\frac{5}{16}$ " – $\frac{13}{32}$ " at walls and any other obstructions, such as columns, heat vents, etc.

It is crucial to plan your layout before you begin so as to ensure proper installation. Normally, it is more aesthetically pleasing to install the flooring in the direction of the longest wall. When establishing a stagger pattern, it is up to your personal preference, but we recommend at least 3 different staggers. The joints should be at least 8" apart, and the end pieces must be no less than 8" long.

Once you've established your horizontal layout, you need to plan your vertical layout so that you are not left with a final board less than 2" in width. To determine the width of the last row, measure the width of the room in inches, and subtract 1" for the approximately $\frac{1}{2}$ " expansion gap left at either wall. Divide this number by the plank width to find out the number of full rows it will take to cover the room. The remainder will be made up with a plank that's ripped to that width. If the remainder is less than 2", we suggest that you split the difference between the first and last row.

Beginning the Installation

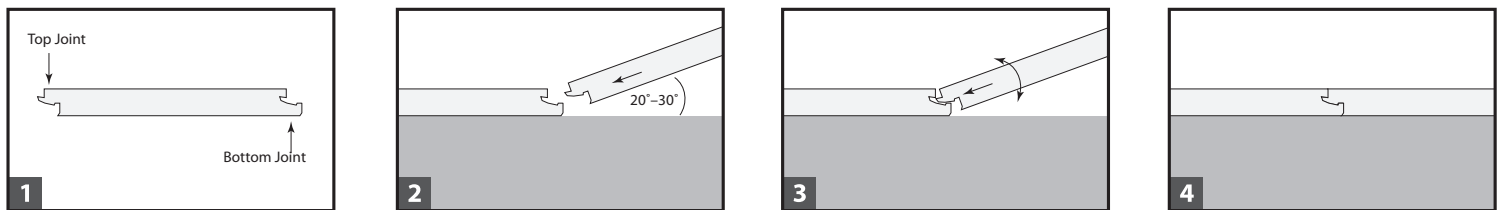

To lock pieces of UniClic® flooring together, lay a piece on the floor with the Bottom Joint facing you (Figure 1). Take another piece, and insert the Top Joint at a 20° – 30° angle (Figure 2). Gently move the piece up and down while exerting forward pressure (Figure 3) until the pieces click into place (Figure 4).

Because bamboo is a natural material, there will be color variations between planks. It is recommended that you open several boxes at a time so as to adequately mix lighter and darker pieces throughout your floor. As you are sorting through planks, be sure to inspect the individual planks for finish and manufacturing defects. It is considered the installer's/owner's responsibility not to install flooring with finish, manufacturing, or unacceptable naturally occurring material variations. Individual planks with defects should not be installed or the defect should be cutout prior to installation. The Bamboo Revolution warranty does not cover materials with visible defects once they are installed. Installation of any material serves as acceptance of that material as delivered.

Once you are comfortable with the way UniClic® flooring locks together, and have sufficiently mixed pieces of the bamboo, you are ready to begin the installation. The first step is to install your underlayment per the manufacturer's instructions. If using Bamboo Revolution 3mm cork (recommended), lay one row of cork at a time, taping the seams together to keep the pieces from separating.

You will want a flat edge wherever your flooring borders a wall. Thus, begin by ripping the Top Joint off your first board. Remember to take into account whether your vertical layout requires your first board to be less than a full width plank.

Proceed with each additional plank in the first row, making sure they are perfectly aligned. This is very important for installing the subsequent rows. Once the first row is in place, install the second row. At this point, make sure the expansion gap is sufficient and adjust if needed. As more rows are added, it will become more difficult to shift.

Continue building one row at a time until the floor is complete.

Installing in Difficult Areas

Because UniClic® flooring is installed at an angle, it can be difficult to lock together in tight areas, such as against a wall. In tight spots, you can tap pieces together using a pull bar and a hammer, or by using a tapping block to tap the pieces together while flat against the base floor.

Installing Over Radiant Floors

Bamboo Revolution's UniClic® strand woven bamboo flooring is suitable for installation over many radiant heating systems as long as the surface temperature of the installed flooring never exceeds 85°F. Due to the fact that radiant heating systems create "dry" heat, it is essential that the relative humidity in the installation environment be maintained between 40-60% and that the maximum difference in moisture content between the sub-floor and the flooring material never exceed 3%. The owner/installer assumes sole responsibility for ensuring that the job site has environmental conditions/controls suitable for the installation of Bamboo Revolution flooring over the chosen radiant heating system. The radiant heat system needs to be in operation for at least 7 days prior to installation, shut off 4 hours prior to installation, and then returned to operation once the installation is complete. When choosing an installer for application over radiant heat, consider a member of the Radiant Panel Association (www.radiantpanelassociation.org).

Notes

- Do not install cabinets or walls on top of floating floor, as this will restrict its ability to expand and contract. Use proper expansion gaps as explained in "Planning Your Layout."
- Always install transition pieces between rooms to allow each space to expand and contract in an unrestricted manner. While transition pieces can be fixed to the subfloor, expansion gaps between the transition piece and the flooring must be preserved. Therefore, trim pieces should overlap and not be affixed to the flooring itself so that the flooring can freely move under the transition piece.

Maintenance

Bamboo Revolution recommends vacuuming or sweeping in order to remove dirt and grit prior to cleaning the flooring. When a spill occurs, make sure to soak up the bulk liquid promptly. As with all natural products, exposure to the sun and ultra-violet rays can accelerate the oxidation of bamboo. Because caramelized bamboo products will lighten and natural bamboo products will tend to darken over time, periodically rearrange rugs and furniture to allow for even aging of the flooring. Use area rugs in high traffic areas. Install wood guards on the feet or legs of furniture.

Do not use wax, oil soap or other household cleaners. Bamboo Revolution recommends using either WoodWise Floor Cleaner by Design Hardwood Products or Bona Swedish Formula® MicroPlus Hardwood Floor Cleaner by BonaKemi.

Proper care and maintenance can extend the life of your floor for many years; however, at some point a re-coat or total refinishing may be desirable. To re-coat your floor and remain in conformance with the Bamboo Revolution warranty, follow the manufacturer's instructions at either of the following:

- Basic Coatings Tykote Sandless Re-coating System (www.BasicCoatings.com)
- BonaPrep™ Re-coating Adhesion System by BonaKemi USA (www.bona.com)